



AL HADAF MARINE SERVICES

M/V SEA ROYAL

5220 BHP/67T BP/DP1/FiFi1/AHTS



PRINCIPAL PARTICULARS

Year Built	2009
Place Built	Fujian Crown Ocean Shipping Industry Co Ltd, China
Manager	Al Hadaf Marine Services
Flag	Sierra Leone
Length Overall	60 m
Length BP	-
Breadth Moulded	16 m
Depth Moulded	6 m
Draft (max)	5.1 m
Freeboard (SLL)	1 m
Class	RINA
Notation	Towing Vessel, AH, FiFi Class1, Offshore Support Vessel, Oil Recovery Vessel Class 1, E+AMS, DPS-1
GRT/ NRT	1706 / 511
Deadweight	1736.91 MT
Bollard Pull	67 MT

DECK PARTICULARS

Clear Deck Area	380 m ²
Deck Carrying Load	600 T
Deck Strength	5 T/m ²

PERFORMANCE

Maximum Speed	13 Knots
Service Speed	10 Knots
Economic Speed	8 Knots

PROPULSION SYSTEM

Main Engines	2 x 2610 BHP @ 750 rpm, Yanmar 6EY26, Total 5220 BHP,
Auxiliary Engines	2 x 275 kW/415V/50, Caterpillar, C18
Emergency Generator	1 x 93.6 kW/415V/50, Caterpillar, C4.4
Bow Thruster	1 x 8 t, Shottel STT2, CPP, Electric-Driven Tunnel
Stern Thruster	1 x 8 t, Shottel STT2, CPP, Electric-Driven Tunnel
Propellers	2 x Berg, CPP with Kort Nozzle
Sewage Plant	1 x 40 Person Capacity, Make: SBT-40
Oily Water Sep.	1 m ³ per hr with 15 ppm alarm

TANK CAPACITIES

Fuel Oil	530 m ³
Fresh Water	460 m ³
Drill/Ballast Water	477 m ³
Liquid Mud	200 m ³
Brine	185 m ³
Dry Bulk	160 m ³
Foam/Detergent	10.6/10.6 m ³

CARGO DISCHARGE CAPACITIES

Fuel Oil Pump	1 x 100 m ³ /hr @ 75 m head
Fresh Water Pump	1 x 100 m ³ /hr @ 75 m head
Drill Water Pump	200 m ³ /hr @ 60 m head
Liquid Mud Pump	2 x 80 m ³ /hr @ 75 m head
Bilge Pump	50 m ³ /hr @ 80 m head
Dry Bulk	20.5 m ³ @ 6 Bar air Pressure

DECK EQUIPMENT

Anchors & Chain	2 x Anchor 1590 kg, Chain 412 m (L) x 38mm (dia)
Tugger Winch	2 x 10 T @ 15 m/min, Plimsoll
Capstan	2 x 5 T @ 15 m/min, Plimsoll
Anchor Windlass	1 x 6.6t @ 12m, Plimsoll
Crane	1 x NORCRANE SWL 3t, 12 m Out reach

ANCHOR HANDLING & TOWING EQUIPMENT

Towing/Anchor Handling	1 x Double drum Electro-Hydraulic Waterfall Plimsoll, 200 tones line pull and 250 brake
Winch	1000m x 56mm each
AH/Towing Drum Cap	1000 m (L) x 56 mm (Dia) SWR
Spare Reel Drum Cap	1000m x 56mm each
Line Pull @ First Layer	150 tones
Brake Holding	250 T (Static)
Towing Pin	SWL 300 T, Electro Hydraulic, Plimsoll
Shark Jaw	SWL 300 T, Electro-Hydraulic, Plimsoll
Stern Roller	SWL 375 T, 4.2 m (L) x 1.6 m (Dia)

ACCOMMODATION

Berths	4 x 1, 5 x 2, 3 x 4 Berths
Total Pax	26 + Hospital

EXTERNAL FIRE-FIGHTING EQUIPMENT

Fi-Fi Notation	Class 1 with Water Curtain All Round
Fi-Fi Monitors	2 x Fi-Fi Monitors, 1200 m ³ /hr, 120 m Throw Length
Fi-Fi Pump	2 x Fi-Fi Pumps, 1200 m ³ /hr

LIFE-SAVING EQUIPMENT

Life Rafts	4 x 25 Men, SOLAS Compliant
Rescue Boat c/w Davit	1 x 15 Men FRB inboard engine + 1 6 men with outboard engine

Particulars are believed to be correct but not guaranteed. Owners reserve the rights to amend the specifications without notifications. Particulars are entirely without warranty as to interested parties must inspect vessel's certificates, drawings or physical inspection of vessel.

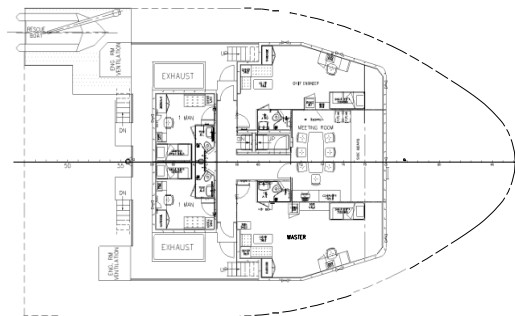
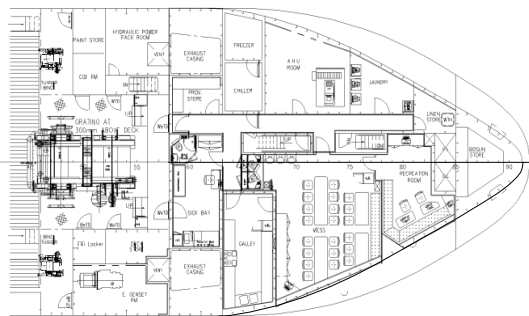
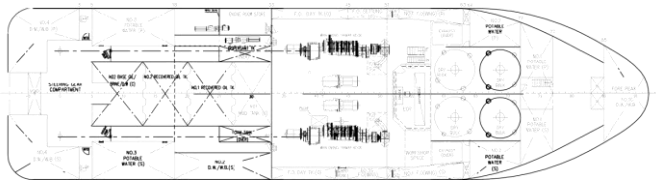
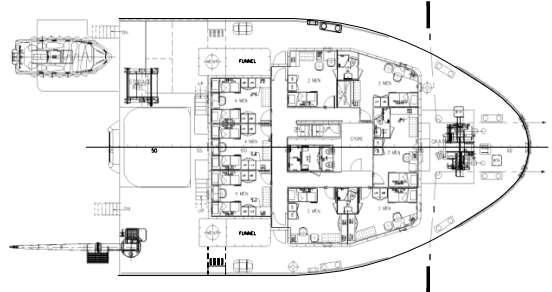
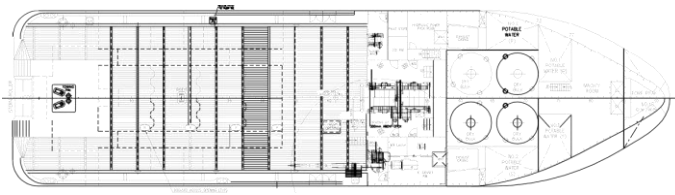
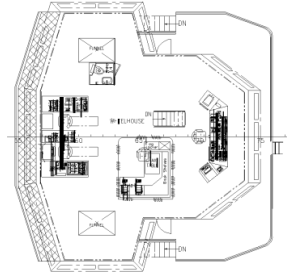
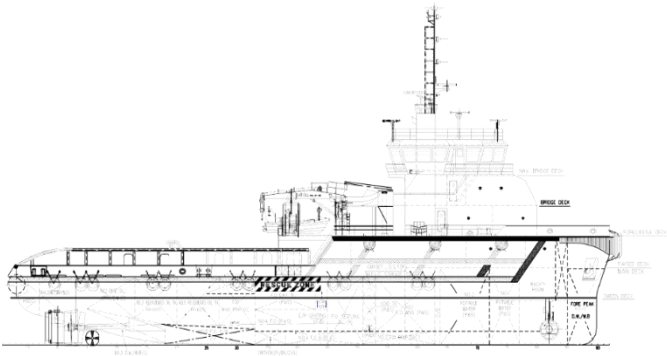

Email : chartering@alhadafmarine.ae
 Website : www.alhadafmarine.ae

Particulars are believed to be correct but not guaranteed. Owners reserve the rights to amend the specifications without notifications. Particulars are entirely without warranty as to interested parties must inspect vessel's certificates, drawings or physical inspection of vessel.